

Seat Heaters

Component Location Index

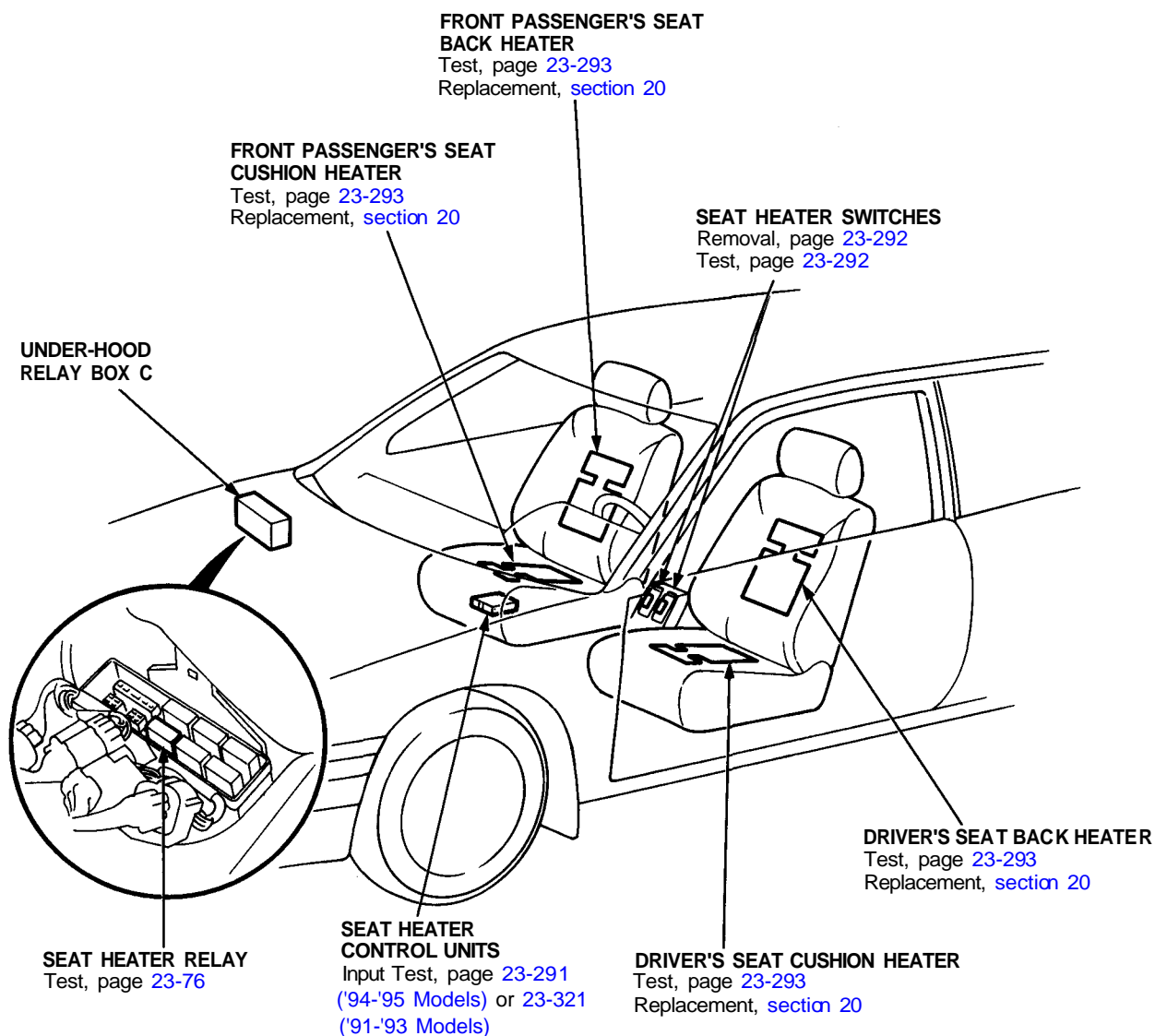

Description

Two heaters are provided in each front seat; one in the seat cushion and one in the seat back. Each heater allows any desired temperature between 84°F and 93°F (29°C and 34°C) by rotating the adjusting dial located on the center console. The heater in the seat cushion uses a temperature-dependent diode (thermistor) to measure differences in the seat temperatures. The use of the thermistor and transistors in the control unit combine to give accurate temperature control.